



E & A CONSULTING GROUP, INC.

Engineering Answers

10909 Mill Valley Road, Suite 100 • Omaha, NE 68154-3950
P 402.895.4700 • F 402.895.3599
www.eacg.com

Dear Homeowner:

The SID has contracted concrete work to be done on the streets in your SID. A contractor will be on site to do work which includes removing the existing concrete that is damaged and replacing it with new pavement.

Throughout the course of this project, there could be some minimal damage done to yards and or sprinkler systems. The contractor that is on site will be responsible for replacing any damaged sprinkler lines and/or heads. They will also be replacing any sod that is torn up while on site. Once the new sod is laid, it will be the responsibility of the homeowner at each lot to water the new sod until it has re-established itself.

Before starting the work on site, each contractor must put in a call and have all the utilities in the area located. You might notice some areas in your yard that have been flagged and/or spray painted. This does not indicate the area in which they will be working. It is just to give them an idea of what kind of utilities are in the area that could possibly be hit while the contractor is on site working.

All work that is completed in public Right-of-Way and follow City of Omaha and Sarpy County specifications.

The work in your SID should not take longer than 30 days to complete. Please let me know if you have any questions or concerns on this at all.

Thank You,

A handwritten signature in black ink, appearing to read 'Chris Anderson', with a long, sweeping underline.

Chris Anderson
Construction Administration Tech.
Engineering Answers...by transforming concepts into reality
E & A Consulting Group, Inc.
10909 Mill Valley Road, Suite 100 • Omaha, NE 68154
402.895.4700 (o)
eacg.com



ARBOR GATE

2024 STREET RECONSTRUCTION

SID NO. 519
DOUGLAS COUNTY, NEBRASKA

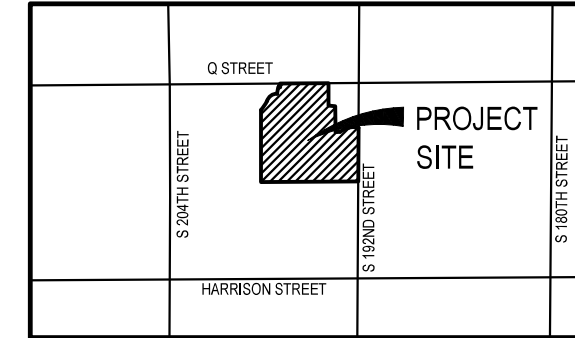

VICINITY MAP

APPROXIMATE BID QUANTITIES

ITEM	DESCRIPTION	QUANTITY	UNIT
1	CONCRETE PAVEMENT REPAIR, SMALL AREA	125	SY
2	FULL DEPTH SAW CUT EXISTING PAVEMENT	284	LF
3	ADJUST MANHOLE TO GRADE	1	EA
4	REMOVE AND REPLACE 6" PCC MULTI-USE TRAIL	54	SF
5	REMOVE AND REPLACE PCC CURB RAMP	29	SF
6	REMOVE AND REPLACE IMPRINTED PCC SURFACE	61	SF
7	REMOVE PCC SIDEWALK	72	SF
8	REMOVE PCC CURB RAMP	242	SF
9	REMOVE IMPRINTED SURFACE	68	SF
10	CONSTRUCT PCC SIDEWALK	158	SF
11	CONSTRUCT PCC CURB RAMP	144	SF
12	CONSTRUCT IMPRINTED PCC SURFACE	69	SF
13	CONSTRUCT DETECTABLE WARNING PANEL (3 locations)	24	SF
14	REMOVE AND REPLACE FAULTY SUBGRADE	25	TN
15	ADJUST SPRINKLER (AS NEEDED)	2	EA
16	PERFORM DIAMOND GRINDING (3 locations)	25	SY



INDEX OF SHEETS

SHEET NO.	DESCRIPTION
1	COVER
2	PLAN



NOTE TO BIDDERS

- All project procedures, materials, bonds and reserves shall conform to the City of Omaha's Standard Specifications for Public Works Construction, 2024 Edition ("Standard Specifications"). It is the responsibility of the CONTRACTOR to be familiar with the contents of the Standard Specifications. The Standard Specifications can be found at: <https://publicworks.cityofomaha.org/contractors-consultants2/contractors/standard-plates-curb-ramps-and-specifications>
- References to "Standard Plates" refers to the City of Omaha's 2024 Standard Plate list. These Standard Plates can be found at: <https://publicworks.cityofomaha.org/2024-standard-plate>

The CONTRACTOR is referred to the following Standard Plates for use on this project:

PLATE NO.	DESCRIPTION	REVISION DATE
1002-02-1, 3, 4	Pavement Repair	02/13/2024
504-01-1	Concrete Curb Ramp	02/13/2024

APPLICANT

SID # 519
Linda Jones, Chairman
11440 West Center Road, Ste. C
Omaha, NE 68114
P: 402.334.0700
F: 402.334.0815
mjohnson@fdjlaw.com

DESIGNER

E & A Consulting Group, Inc
Teresa Wooten, P.E.
10909 Mill Valley Road, Suite 100
Omaha, NE 68154
P: 402.895.4700
F: 402.895.3599
twooten@eacg.com

INSPECTOR

E & A Consulting Group, Inc
Randall L. Pierce, P.E.
10909 Mill Valley Road, Suite 100
Omaha, NE 68154
P: 402.895.4700
F: 402.895.3599
rpierce@eacg.com

CONTRACTOR

E & A CONSULTING GROUP, INC.
Engineering • Planning • Environmental & Field Services
10909 Mill Valley Road, Suite 100 • Omaha, NE 68154
Phone: 402.895.4700 • Fax: 402.895.3599
www.eacg.com
State of NE Certificate of Authorization MC40008

ARBOR GATE 2024 STREET RECONSTRUCTION
SID 519
DOUGLAS COUNTY, NEBRASKA

COVER

Revisions
Date Description
5/14/2024
Designed By: TAM
Drawn By: JME
Scale: 1" = 40'
Sheet: 1 of 2

5/14/2024 2:04 PM K:\Projects\2004\204\p25\Engineering\CAD Files\Paving\Arbor Gate 2024 Street Reconstruction-000.dwg
Jessica Brown

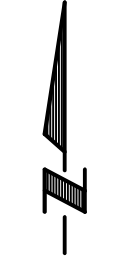
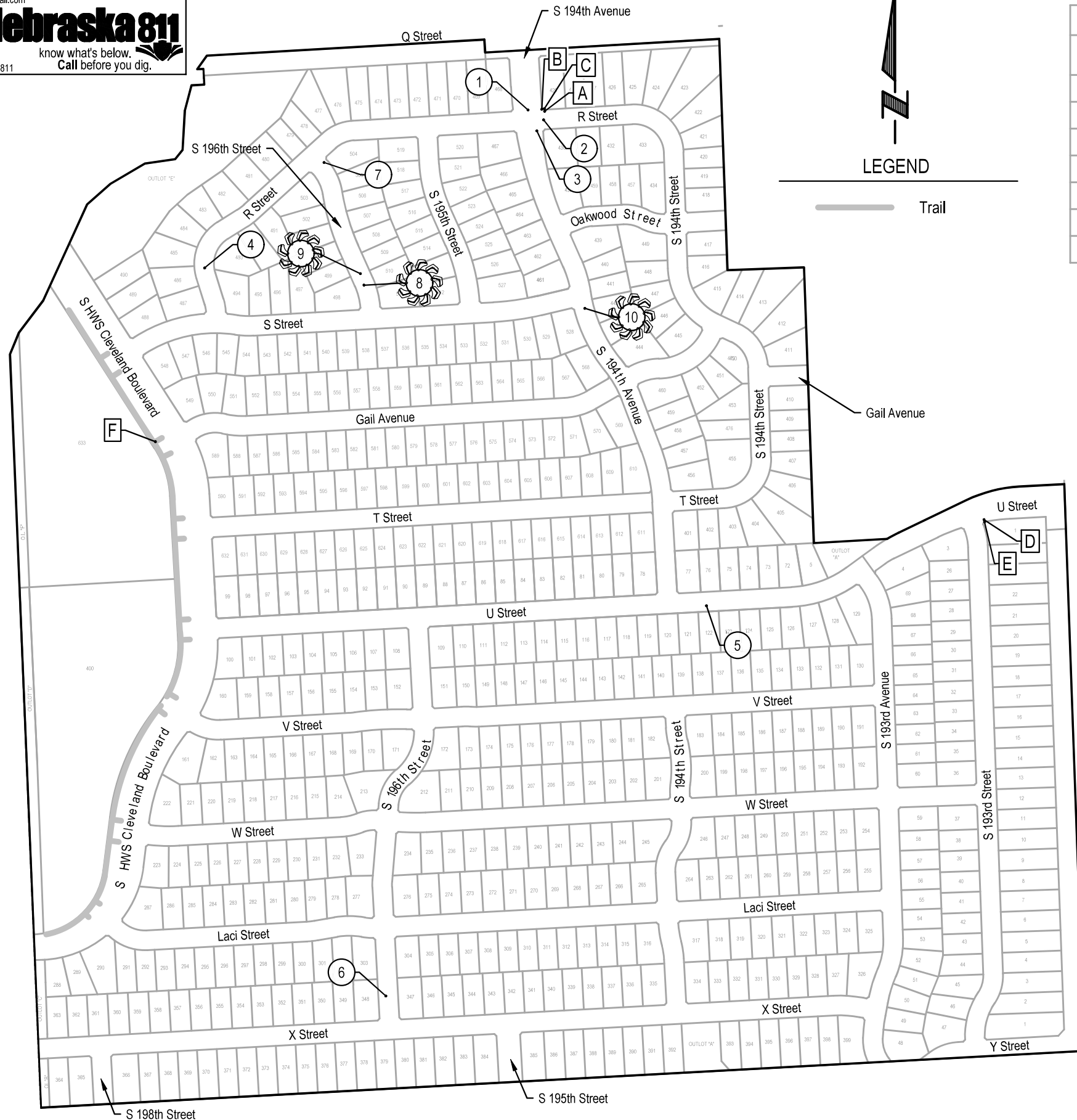

LEGEND



2024 STREET RECONSTRUCTION									
AREA NO.	NO. POURS	SAW CUT L.F.	CURB L.F.	WIDTH	X	LENGTH	LARGE AREA EST S.Y.	SMALL AREA EST S.Y.	NOTES
1	1	26		13.0	x	13.0		18.8	
2	1	16	7	4.0	x	5.0		2.2	
3	1	36	14	14.0	x	11.0		17.1	
4	2	50	24	25.0	x	12.0		33.3	
5	1	38	13	12.5	x	13.0		18.1	
6	1	39	14	12.5	x	14.0		19.4	
7	1	36	12	10.0	x	14.0		15.6	

2024 STREET RECONSTRUCTION				
AREA NO.	TYPE	APPROX. DIMEN.	EST S.F.	NOTES
A	Curb Ramp	15.6 x 15.5	241.8	REMOVE
	Curb Ramp	12.0 x 12.0	144.0	CONSTRUCT, ADA Plate - Cast Iron - (QTY 2)
B	Imprinted Surface	7.8 x 8.8	67.8	REMOVE
	Imprinted Surface	6.0 x 11.5	69.0	CONSTRUCT, Adjust Manhole
C	Sidewalk	4.0 x 18.0	72.0	REMOVE
	Sidewalk	4.5 x 35.0	157.5	CONSTRUCT, Adjust Sprinkler
D	Curb Ramp	4.8 x 6.0	28.5	REMOVE & REPLACE, ADA Plate - Cast Iron, Adjust Sprinkler
E	Imprinted Surface	4.5 x 13.5	60.8	REMOVE & REPLACE
F	6" Trail	6.0 x 9.0	54.0	REMOVE & REPLACE

2024 STREET RECONSTRUCTION - DIAMOND GRINDING				
AREA NO.	TYPE	APPROX. DIMEN.	EST S.Y.	NOTES
8	Diamond Grinding	3 x 25	8.3	
9	Diamond Grinding	3 x 25	8.3	
10	Diamond Grinding	3 x 25	8.3	

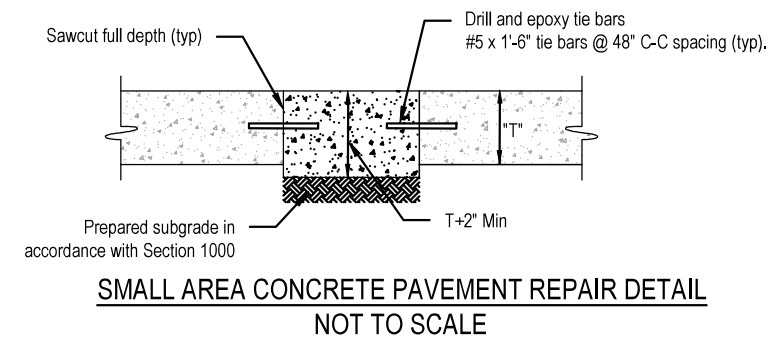

E & A CONSULTING GROUP, INC.
 Engineering • Planning • Environmental & Field Services
 10809 Mill Valley Road, Suite 100 • Omaha, NE 68154
 Phone: 402.265.4700 • Fax: 402.265.2599
 www.eandagroup.com
 State of NE Certificate of Authorization #CA0008

E & A CONSULTING GROUP, INC.
 Engineering Answers

ARBOR GATE
 2024 STREET
 RECONSTRUCTION
 SID 519
 DOUGLAS COUNTY, NEBRASKA

PLAN

5/14/2024 2:04 PM
 K:\Projects\2004\2064\p25\Engineering\CAD Files\Paving\Arbor Gate 2024 Street Reconstruction-000.dwg
 Jessica Brown

Revisions	Date	Description
1	5/14/2024	TAM
2		JMB

Scale: T = 30'
 Sheet: 2 of 2